

2907WB

Accuride®

- GB** Installation Guide
- D** Einbauanleitung
- F** Guide d'installation
- I** Guida all'installazione
- E** Guía de instalación
- S** Installationsanvisningar

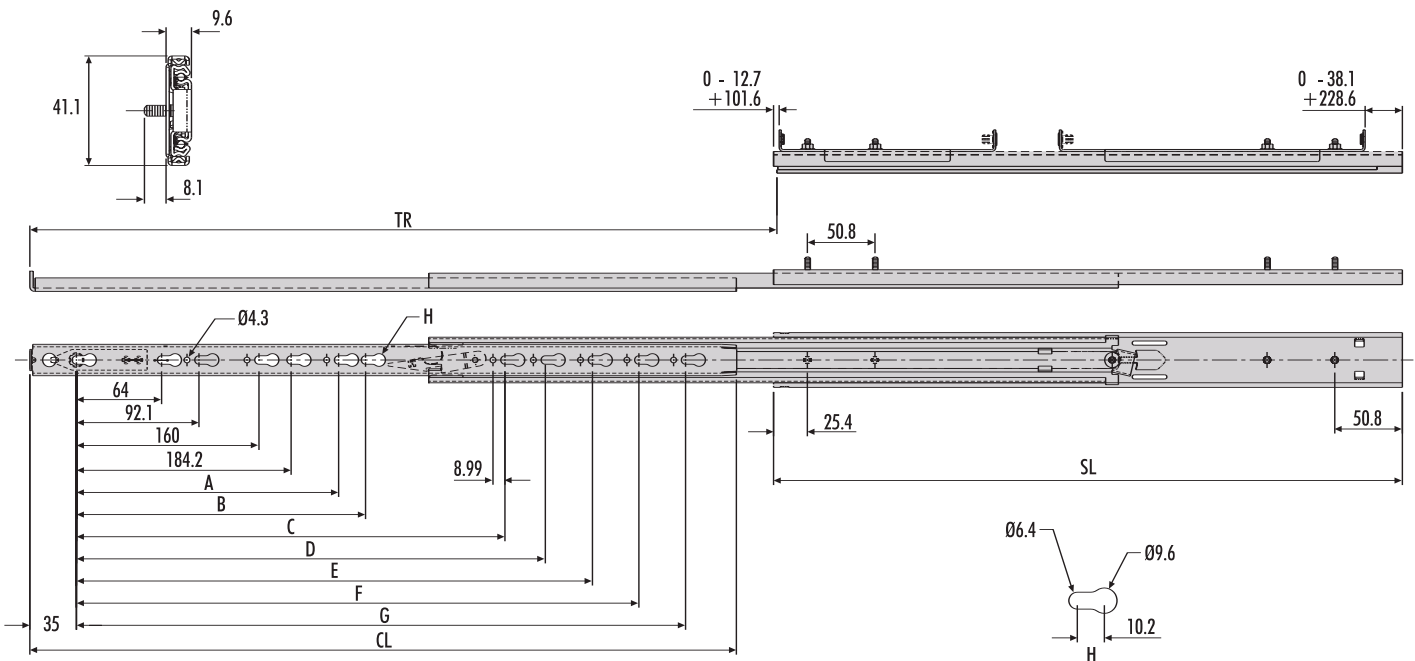
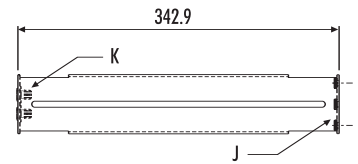
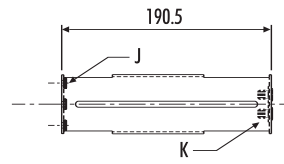
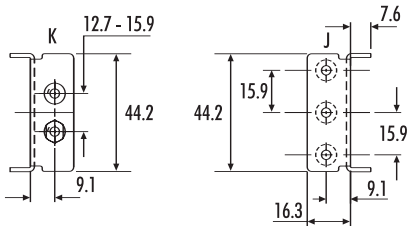
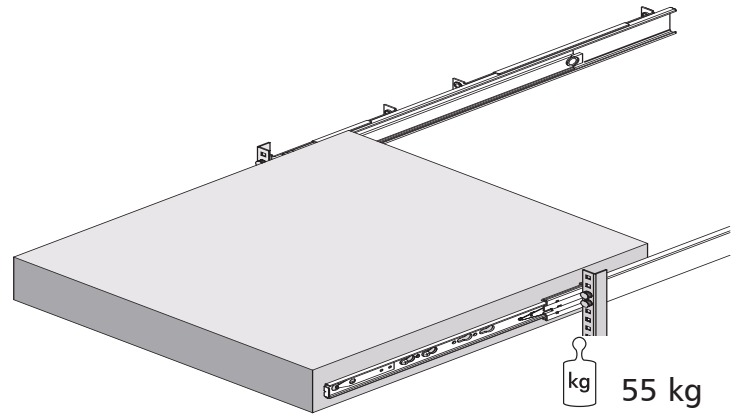

| 2907WB | mm | | | | | | | | | |
|-----------------|-----|-----|-----|-----|-------|-------|-----|-------|-----|-------|
| | SL | CL | TR | A | B | C | D | E | F | G |
| DZ2907-0022WB-2 | 584 | 558 | 610 | - | - | 368.3 | 416 | 460.4 | - | - |
| DZ2907-0024WB-2 | 635 | 608 | 660 | - | - | 368.3 | 416 | 460.4 | 512 | - |
| DZ2907-0026WB-2 | 686 | 659 | 711 | 256 | 276.2 | - | 416 | 460.4 | 512 | 552.5 |

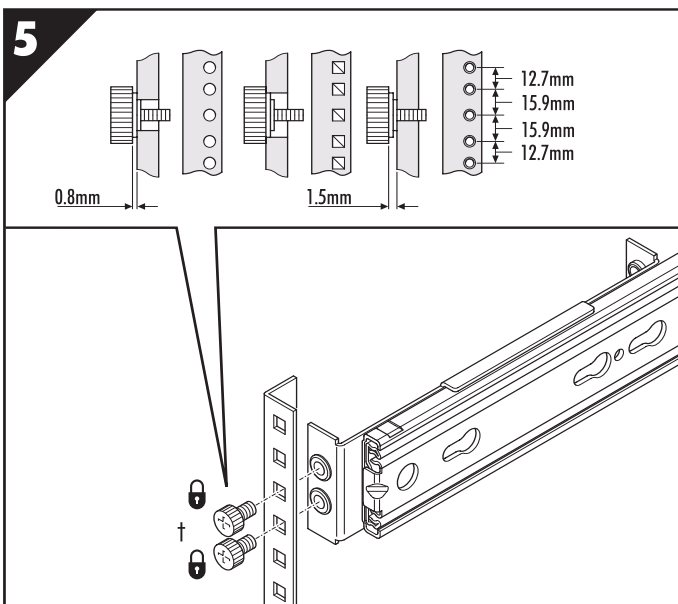
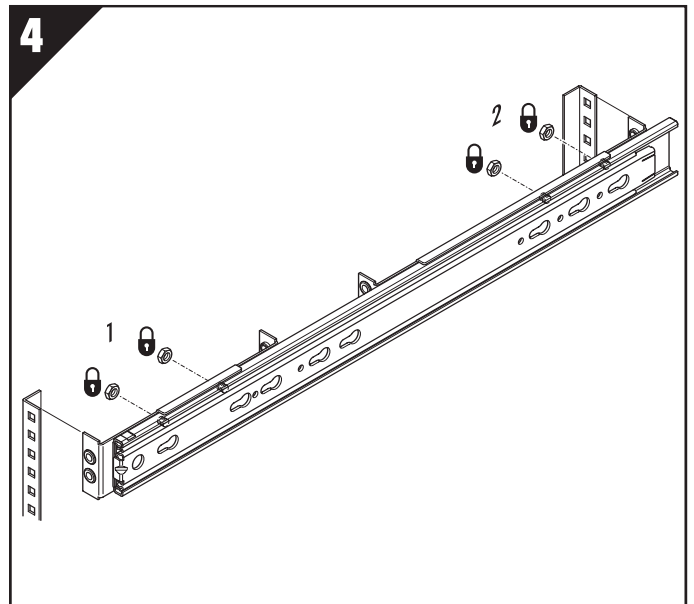
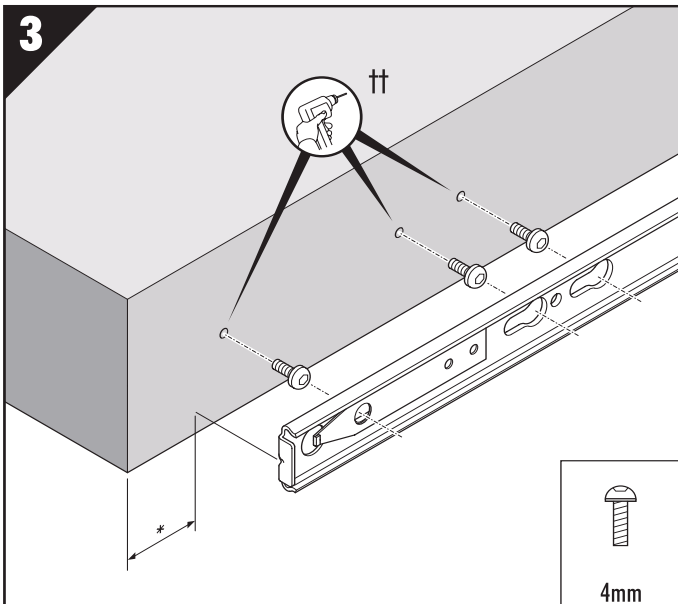
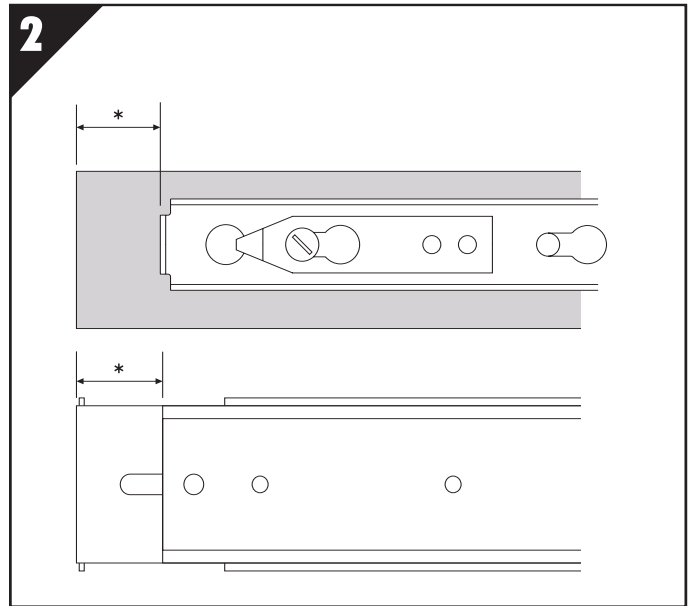
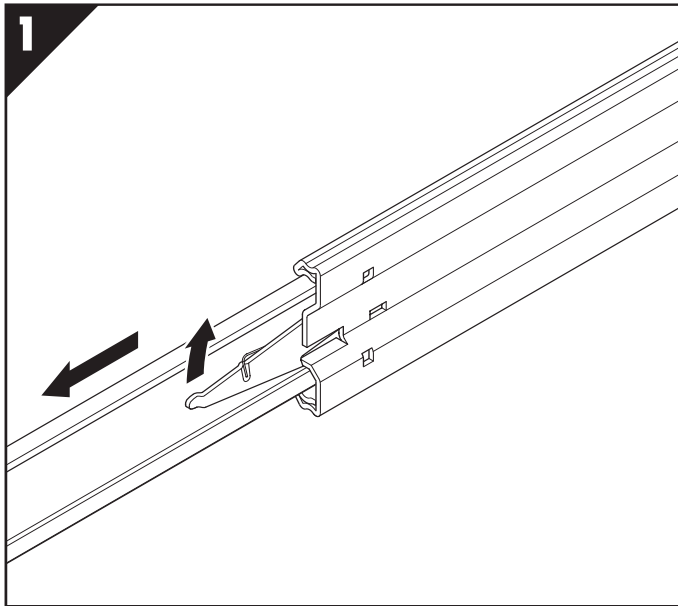

- i** **2907WB**
- (GB)** * Record this dimension when installing the cabinet member to the front bracket.
 - † For a front flush fascia use a No. 8-32 fillester head with cage nut.
 - †† If required.
 - (D)** * Vermerken Sie sich dieses Mass, wenn Sie die Innenschiene an den vorden Winkel befestigen.
 - † Für Front-Verkleidungen benutzen Sie bitte eine Linsenschraube 8-32 mit Käfigmutter.
 - †† Falls eforderlich.
 - (F)** * Lors du montage du brin fixe de la glissière sur l'équerre de fixation avant, relever cette dimension.
 - † Pour un montage avec tête de vis affleurante, utiliser des vis 8-32 UNC à tête cylindrique fendue et des écrous cage.
 - †† Si nécessaire.
 - (I)** * Annotare questa dimensione quando si installa la patre al mobile sulla staffa.
 - † Per la fascia frontale a filo utilizzare da 8a 32 viti con testa cilindrica e dado in gabbia.
 - †† A richiesta.
 - (E)** * Apunte esta dimensión cuando se monta el miembro del armario a la escuadra delantera.
 - † Para una tabica delantera enrasada use un tornillo No. 8-32 cabeza cilindrica ranurada y tuerca de jaula.
 - †† Si necesario.

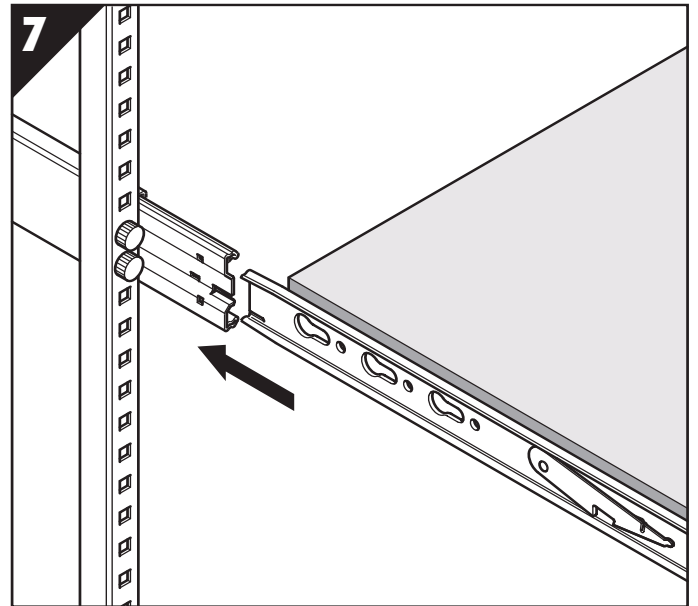
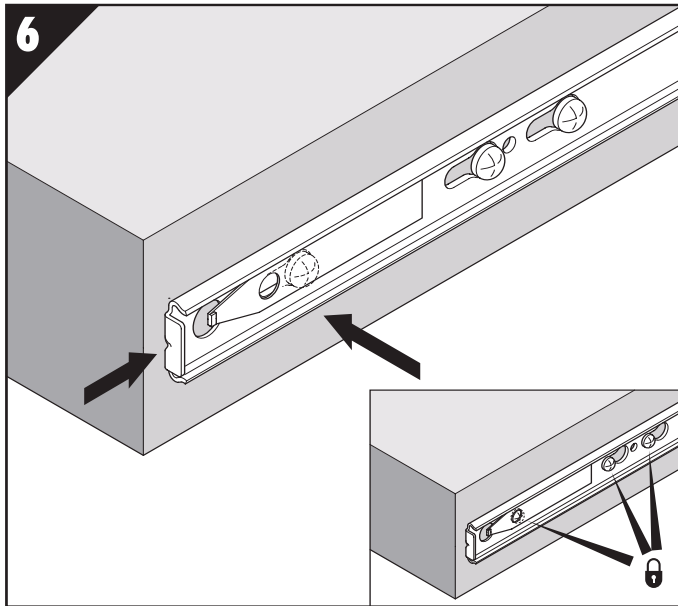

Accuride International Ltd.

Liliput Road, Brackmills Industrial Estate, Northampton
NN4 7AS, United Kingdom.

Tel: +44 (0) 1604 761111 Fax: +44 (0) 1604 767190

E-mail: saleseurope@accuride.com

www.accuride-europe.com

GB If you require further assistance, please contact your distribution agent or supplier.
Accuride reserve the right to alter specifications without notice.

D Bei Fragen wenden Sie sich bitte an Ihren Vertriebspartner.
Technische Änderungen vorbehalten.

F Pour de plus amples renseignements, veuillez contacter votre distributeur.
Accuride se réserve le droit de modifier les spécifications sans préavis.

Accuride International GmbH

Postfach 1464, D-65573 Diez/Lahn, Germany
Werner-von-Siemens-Str. 16-18,

D-65582 Diez/Lahn

Tel: + 49 (0) 6432 608-0 Fax: + 49 (0) 6432 608-320

www.accuride.de

I Qualora necessitate di ulteriore assistenza, contattate il fornitore o il vostro agente.
Accuride si riserva il diritto di apportare modifiche senza ulteriore comunicazione.

E Si necesita más ayuda, póngase en contacto con su agente de distribución o proveedor.
Accuride se reserva el derecho de alterar las especificaciones sin aviso previo.

S Om det krävs mer hjälp, var vänlig kontakta distributionsombud eller leverantör.
Accuride reserverar sig för ev konstruktionsändringar.

